

C.V. = 6.150  
 C.P. = 5.959  
 L.O.M. = 240.005  
 K.V. = 36662.300  
 B.S. = 0.221

C.V. = 6.000  
 C.P. = 5.880  
 L.O.M. = 240.005  
 K.V. = 12581.000  
 B.S. = 0.120

C.V. = 4.800  
 C.P. = 4.800  
 L.O.M. = 420.002  
 K.V. = 980.277  
 B.S. = -0.277

C.V. = 5.600  
 C.P. = 5.772  
 L.O.M. = 599.202  
 K.V. = 508.950  
 B.S. = 0.028

C.V. = 4.800  
 C.P. = 4.712  
 L.O.M. = 688.032  
 K.V. = 232.100  
 B.S. = -0.035

P.K.	COTAS RASANTE	COTAS TERRENO
0.0	5.37	5.13
50.0	5.49	5.01
100.0	5.61	5.01
150.0	5.67	4.96
200.0	5.70	4.86
250.0	5.78	5.10
300.0	5.79	5.11
350.0	5.87	5.20
400.0	5.93	5.36
450.0	5.98	5.44
500.0	6.02	5.38
550.0	6.04	5.33
600.0	6.06	5.20
650.0	6.06	5.13
700.0	6.05	5.50
750.0	6.01	5.50
800.0	5.95	6.27
850.0	5.85	6.70
900.0	5.72	6.80
950.0	5.56	6.74
1000.0	5.38	5.52
1050.0	5.23	4.68
1100.0	5.13	4.09
1150.0	5.08	3.31
1200.0	5.07	2.97
1250.0	5.10	3.30
1300.0	5.18	2.82
1350.0	5.30	2.94
1400.0	5.42	2.91
1450.0	5.54	2.90
1500.0	5.67	2.90
1550.0	5.77	2.90
1600.0	5.89	2.90
1650.0	5.99	2.90
1700.0	5.99	2.90
1750.0	5.99	2.90
1800.0	5.99	2.90
1850.0	5.99	2.90
1900.0	5.99	2.90
1950.0	5.99	2.90
2000.0	5.99	2.90
2050.0	5.99	2.90
2100.0	5.99	2.90
2150.0	5.99	2.90
2200.0	5.99	2.90
2250.0	5.99	2.90
2300.0	5.99	2.90
2350.0	5.99	2.90
2400.0	5.99	2.90
2450.0	5.99	2.90
2500.0	5.99	2.90
2550.0	5.99	2.90
2600.0	5.99	2.90
2650.0	5.99	2.90
2700.0	5.99	2.90
2750.0	5.99	2.90
2800.0	5.99	2.90
2850.0	5.99	2.90
2900.0	5.99	2.90
2950.0	5.99	2.90
3000.0	5.99	2.90
3050.0	5.99	2.90
3100.0	5.99	2.90
3150.0	5.99	2.90
3200.0	5.99	2.90
3250.0	5.99	2.90
3300.0	5.99	2.90
3350.0	5.99	2.90
3400.0	5.99	2.90
3450.0	5.99	2.90
3500.0	5.99	2.90
3550.0	5.99	2.90
3600.0	5.99	2.90
3650.0	5.99	2.90
3700.0	5.99	2.90
3750.0	5.99	2.90
3800.0	5.99	2.90
3850.0	5.99	2.90
3900.0	5.99	2.90
3950.0	5.99	2.90
4000.0	5.99	2.90
4050.0	5.99	2.90
4100.0	5.99	2.90
4150.0	5.99	2.90
4200.0	5.99	2.90
4250.0	5.99	2.90
4300.0	5.99	2.90
4350.0	5.99	2.90
4400.0	5.99	2.90
4450.0	5.99	2.90
4500.0	5.99	2.90
4550.0	5.99	2.90
4600.0	5.99	2.90
4650.0	5.99	2.90
4700.0	5.99	2.90
4750.0	5.99	2.90
4800.0	5.99	2.90
4850.0	5.99	2.90
4900.0	5.99	2.90
4950.0	5.99	2.90
5000.0	5.99	2.90
5050.0	5.99	2.90
5100.0	5.99	2.90
5150.0	5.99	2.90
5200.0	5.99	2.90
5250.0	5.99	2.90
5300.0	5.99	2.90
5350.0	5.99	2.90
5400.0	5.99	2.90
5450.0	5.99	2.90
5500.0	5.99	2.90
5550.0	5.99	2.90
5600.0	5.99	2.90
5650.0	5.99	2.90
5700.0	5.99	2.90
5750.0	5.99	2.90
5800.0	5.99	2.90
5850.0	5.99	2.90
5900.0	5.99	2.90
5950.0	5.99	2.90
6000.0	5.99	2.90
6050.0	5.99	2.90
6100.0	5.99	2.90
6150.0	5.99	2.90
6200.0	5.99	2.90
6250.0	5.99	2.90
6300.0	5.99	2.90
6350.0	5.99	2.90
6400.0	5.99	2.90
6450.0	5.99	2.90
6500.0	5.99	2.90
6550.0	5.99	2.90
6600.0	5.99	2.90
6650.0	5.99	2.90
6700.0	5.99	2.90
6750.0	5.99	2.90
6800.0	5.99	2.90
6850.0	5.99	2.90
6900.0	5.99	2.90
6950.0	5.99	2.90
7000.0	5.99	2.90
7050.0	5.99	2.90
7100.0	5.99	2.90
7150.0	5.99	2.90
7200.0	5.99	2.90
728.5	4.80	3.31

PERFIL LONGITUDINAL E.: 1/

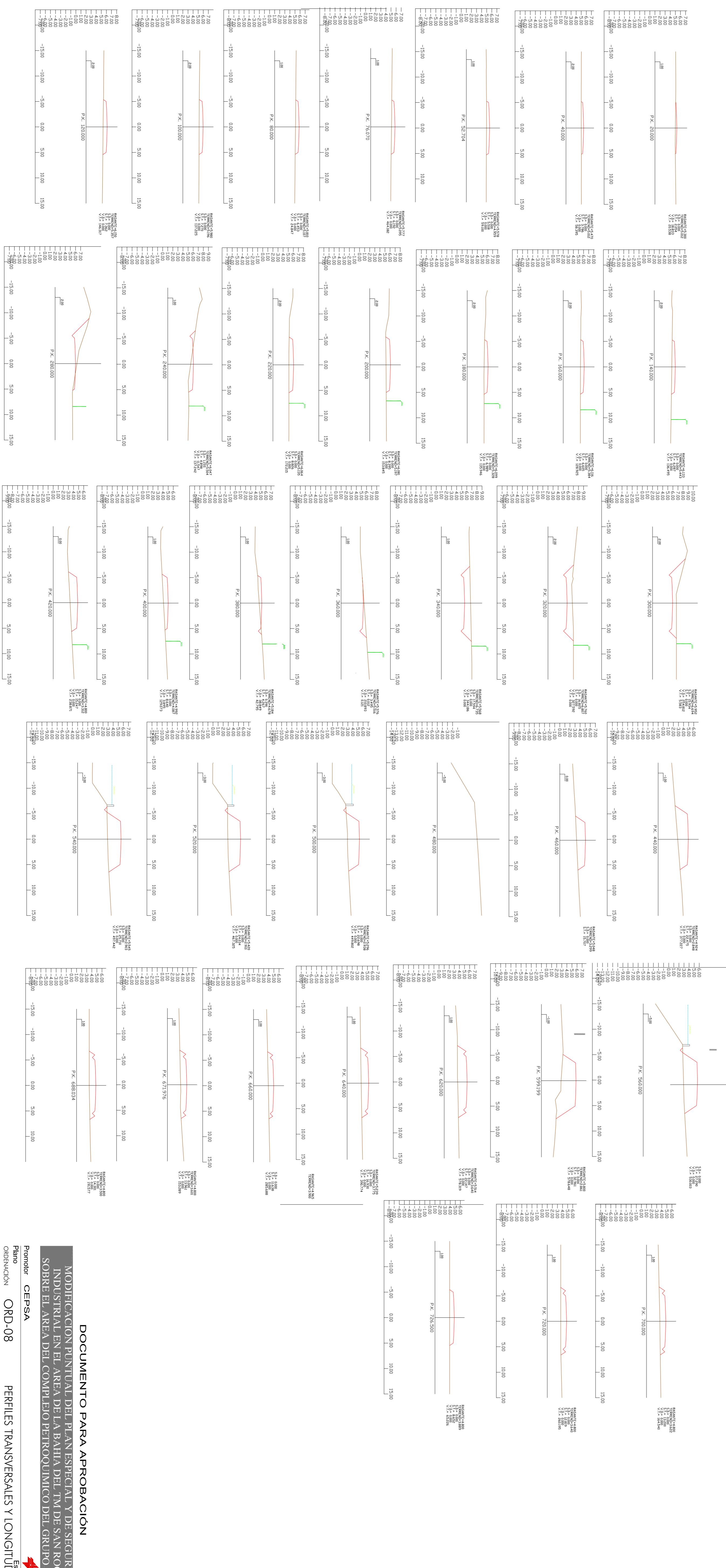

PERFILES TRANSVERSALES E.: 1/400

DOCUMENTO PARA APROBACION

MODIFICACION PUNTUAL DEL PLAN ESPECIAL Y DE SEGURIDAD INDUSTRIAL EN EL AREA DE LA BAHIA DEL TM DE SAN ROQUE, SOBRE EL AREA DEL COMPLEJO PETROQUIMICO DEL GRUPO CEPSA

Promotor: CEPSA  
 Plano: ORD-08  
 Arquitectos: J. MANUEL GONZALEZ TORO, J. MANUEL GONZALEZ TORO, J. MANUEL GONZALEZ TORO  
 Escala: Vertical  
 PERFILES TRANSVERSALES Y LONGITUDINAL